

4

3

2

1

CUSTOMER APPROVAL SIGNATURE

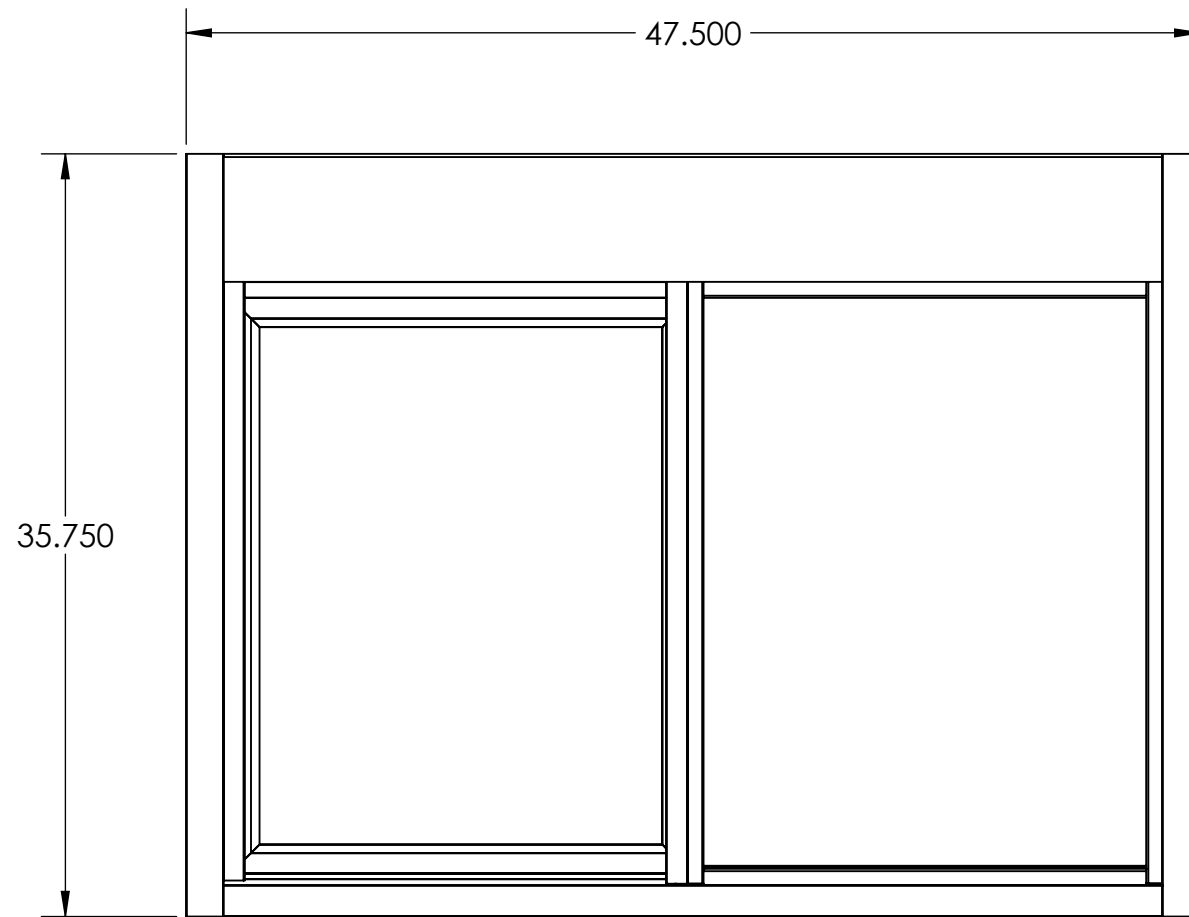

MODEL 275
L/R DIRECTION FROM OUTSIDE VIEW
OPERATION: MANUAL OPEN / SELF-CLOSE
1/4" CLEAR TEMPERED GLASS
SERVICE OPENING 19.75"W x 27.25"H

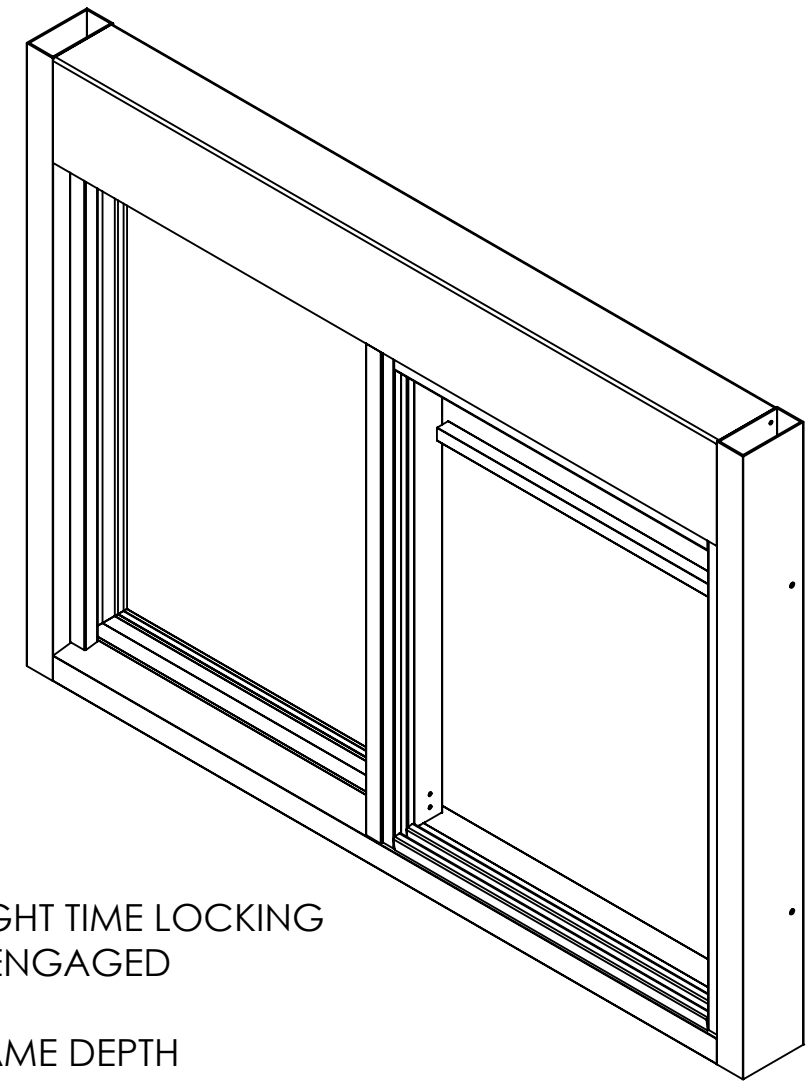

VIEW WITH NIGHT TIME LOCKING
 BAR ENGAGED
 4" FRAME DEPTH

B

B

A

A

WORK TO DIMENSIONS- DO NOT SCALE
 TOL. UNLESS SPECIFIED
 XXXX TOL. NOT REQD
 TOL. CLASS ± .063
 ANGULAR TOL. ± 1°

USED IN PRODUCTS:

DESIGN BY: BCG

MATERIAL: ALUM.

DATE: 4/11/2024

MATERIAL SPEC: 6063-T6

REVISION: A

DRAWN BY: KMS

GAUGE: .063

REVISION DATE:

DATE: 4/11/2024



1815 Arthur Drive, West Chicago, Illinois 60185. 800-621-5045. 630-876-7766. Fax 630-878-7767

LATEST REVISION NOTE:
 REV = A RELEASE FOR CUSTOMER APPROVAL

DESCRIPTION: 47.5"W X 35.75"H - FRAME SIZE
 19.75"W x 27.25"H - SERVICE OPENING

PART NO.:

4

3

2

1